

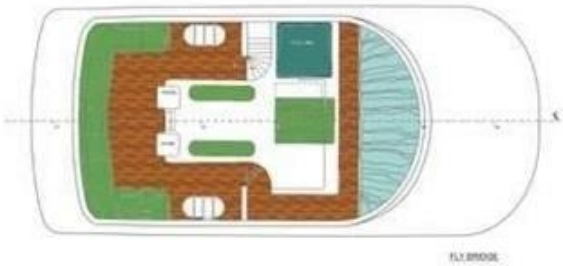

GENERAL ARRANGEMENT 132' AMELS 1988 M/Y MONTE CARLO

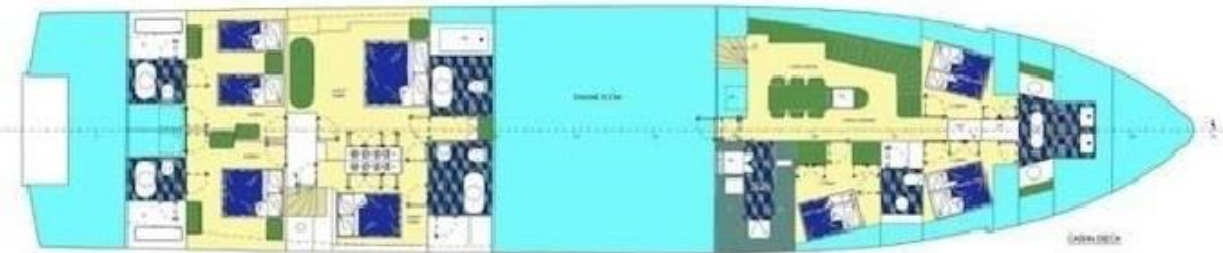

REVISIONS:
1. 11/11/11 - Initial structural arrangement
2. 11/11/11 - Structural layout
3. 11/11/11 - Structural layout



REVISIONS:
1. 11/11/11 - Initial structural arrangement
2. 11/11/11 - Structural layout
3. 11/11/11 - Structural layout